

Russell Taylors

E-WARRANTY



SCAN HERE

CORDLESS VACUUM CLEANER

www.russelltaylors.co.uk



V11

IMPORTANT SAFEGUARDS

This product is powered by a 25.9V DC lithium battery, and all other battery models shall be avoided. In case of any abnormality in the battery, please don't start the product and contact our After-Sales Department. When plugging in/out the power line, please hold the power plug of charging adapter to avoid a forceful pull or twist.

1. Please do not use this machine outdoors or in humid places, or grasp it with wet hands.
2. If the machine is damaged due to collision or falling, placed outdoors or fallen into water, please stop using and send it to the service center authorized by Russell Taylors for inspection.
3. To avoid blocking, please don't put large objects into the suction nozzle of the vacuum cleaner.
4. To avoid injury during using, keep your hair, clothes, fingers and other body parts away from the suction nozzle and movable parts.
5. Avoid sucking in any burning or smoking garbage, such as cigarette ends, matches, soot and other objects.
6. Do not use the vacuum cleaner to clean flammable substances or liquids, such as gasoline or the places where there may be gasoline, kerosene, paint, alcohol, detergent, etc.
7. Do not use the vacuum cleaner before installing the filter.
8. Please turn off the vacuum before connecting or replacing any accessories.
9. Keep the vacuum cleaner indoors and use it in dry rooms only.
10. Using of unknown batteries may result in damage of motor or injury of user, only use the battery provided.
11. Do not use it for other purposes unless otherwise specified in the manual.
12. Do not use the vacuum cleaner as a toy. If there are children in the using environment, please pay special attention to the vacuum being used safely.
13. Be careful when cleaning stairs.
14. To prevent injury and accident, please contact with the After-Sales Service Center of Russell Taylors or the authorized service center for repair if the vacuum cleaner is damaged.

15. Please use the machine correctly according to the manual. Only the accessories provided by the manufacturer can be used for this product.

PRODUCT WARRANTY

- This appliance has been designed for domestic dry vacuum cleaning only. Any evidence of commercial use will result in void of warranty.
- The vacuum cleaner is backed by a 2-year manufacturing warranty (The battery pack is covered by a 6-month warranty).

INTRODUCTION TO PRODUCT COMPONENTS

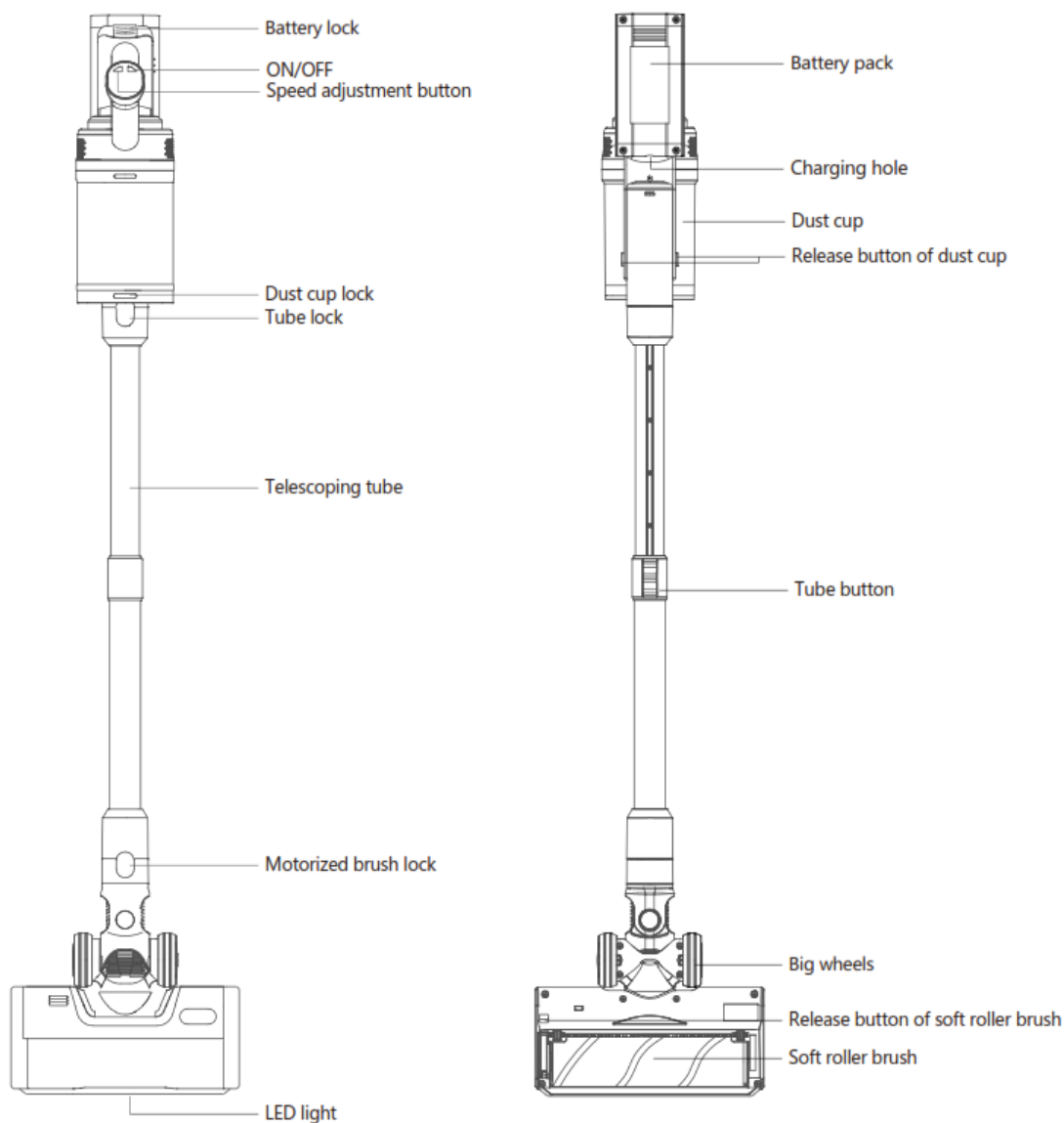



Adapter

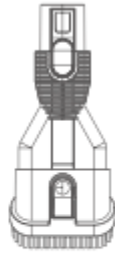

2-in-1 bristle
brush



Long crevice
nozzle

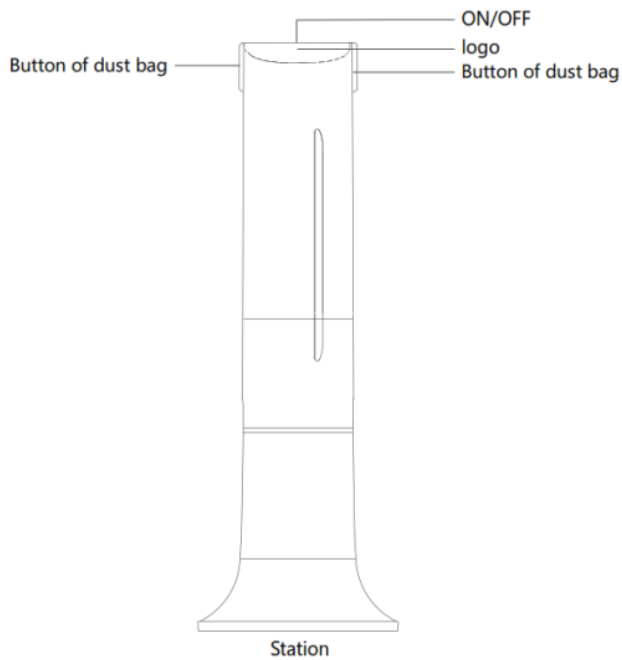

INSTALLATION OF MOTORIZED BRUSH HEAD

As shown in the figure, align the motorized brush to the tube connector, push it gently. Installation is finished when a “click” is heard (for disassembly, press lock button and pull it).

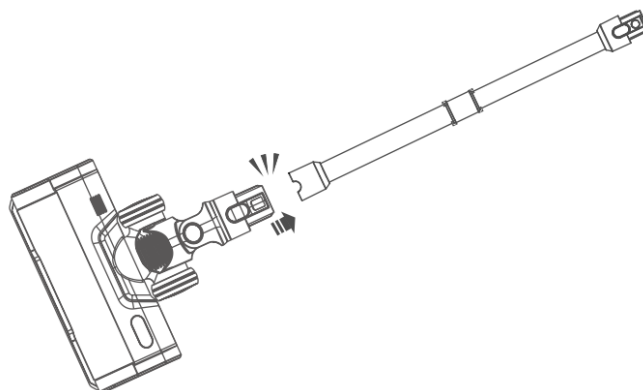

INSTALLATION OF TELESCOPIC TUBE

Use one end of telescopic tube to connect the vacuum first. (It is installed successfully if a “click” is heard), and motorized brush with the other end (as shown in the figure):

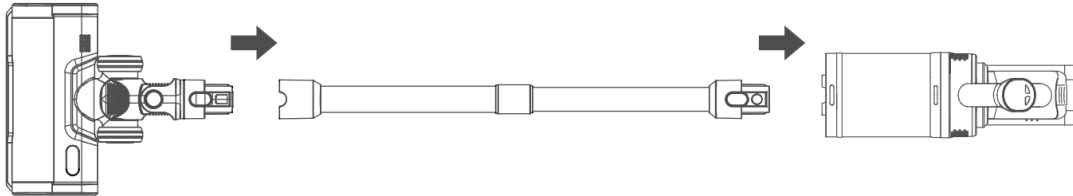

INSTALLATION OF 2 IN 1 BRISTLE BRUSH/LONG CREVICE TOOL

As shown in the figure, align the 2 in 1 bristle brush or long crevice nozzle to the vacuum body connector, and push it gently. The installation is finished when a “click” is heard (for disassembly, just press the lock button showed in the figure and pull it downward).

Connect 2 in 1 bristle brush or long crevice nozzle to clean the area (Such as ceiling, curtain and air conditioning inlet) that is hard to clean.

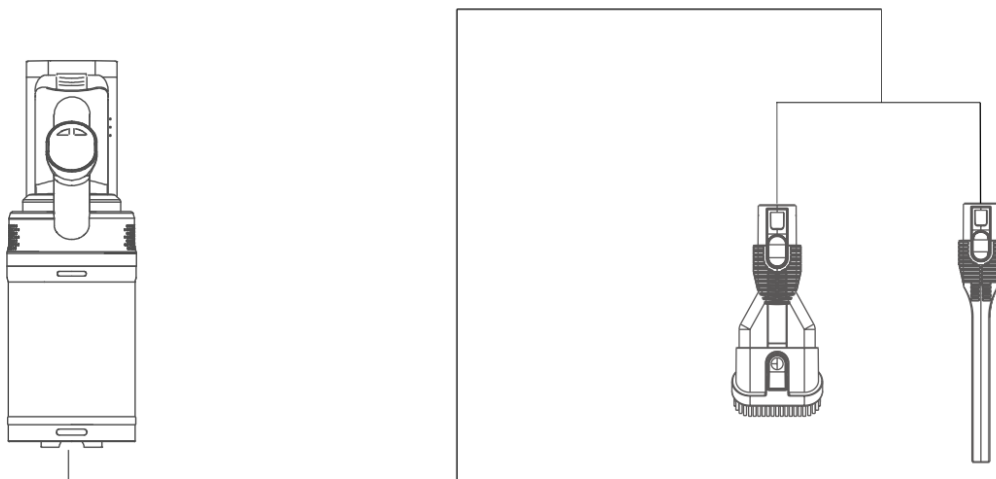

REMOVAL OF DUST CUP

1. Press the release button of the dust cup on the left and right sides as shown in the picture below, and remove the dust cup in the direction indicated by the arrow.
2. Take out the filters and HEPA Filter from the dust cup.

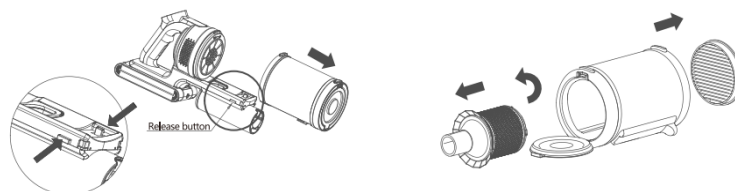

INSTALLATION OF DUST CUP

1. Align the convex point of the filters with the notch position of dust cup as shown in the picture, then put the filters into the dust cup. Make sure the gaps are perfectly aligned before placing the HEPA Filter in.

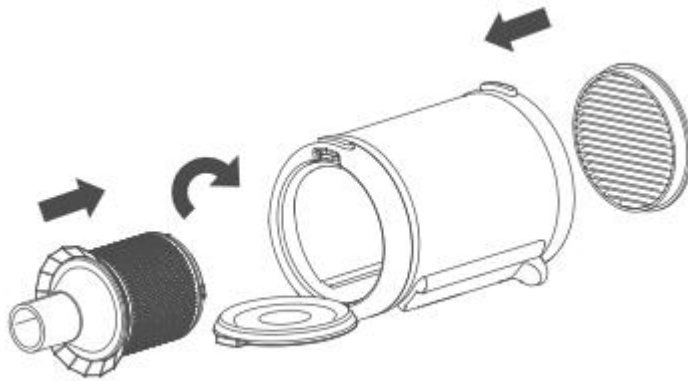

2. Place the notch in the dust cup at the convex point on the top of machine, as shown in the picture on the right, press down to install dust cup in place.

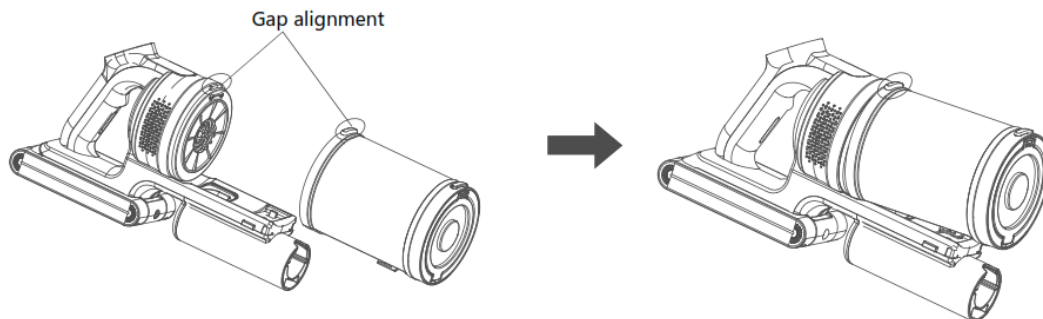

DUST BAG REMOVAL

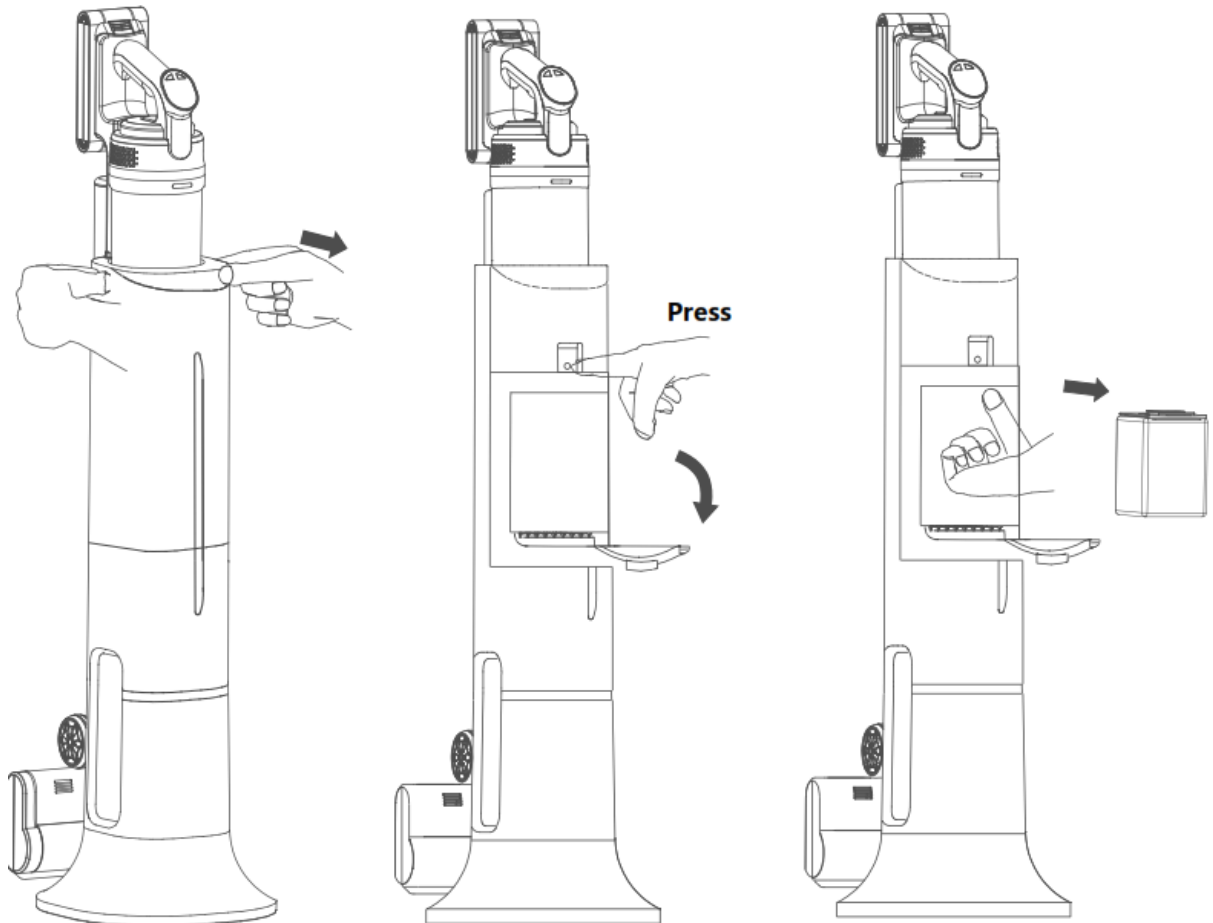

1. Press the button along the dust container with both hands, and remove the outer cover in the direction of the arrow.
2. Press the button with your finger and the cover will open automatically.
3. Pull the dust bag out in the direction of the arrow.

HOW TO USE THE VACUUM CLEANER

1. Insert the battery into the vacuum cleaner as shown. After installation, hold the power button for 2 seconds to start the vacuum. When using, the indicator light on the battery pack will turn blue.

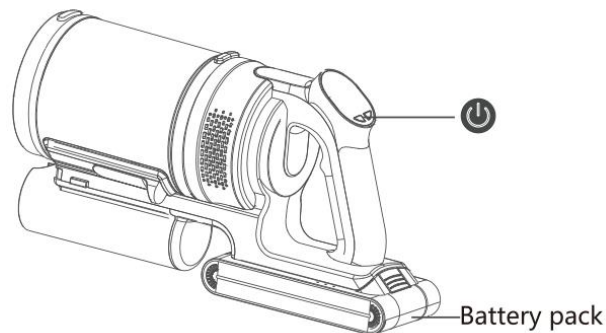

2. After the machine turns on, it will automatically enter ECO mode. Pressing the "+/-" key will enter its AUTO mode and the vacuum will adjust the suction based on the dust collected. Press the "+/-" button again to enter POWERFUL mode.
3. Connect the adaptor to the charging port on the battery pack and then connect the power supply to start charging. While charging, the battery pack will blink in blue. Once all three indicators are lit blue, the charging is complete.

HOW TO USE THE CHARGING STATION

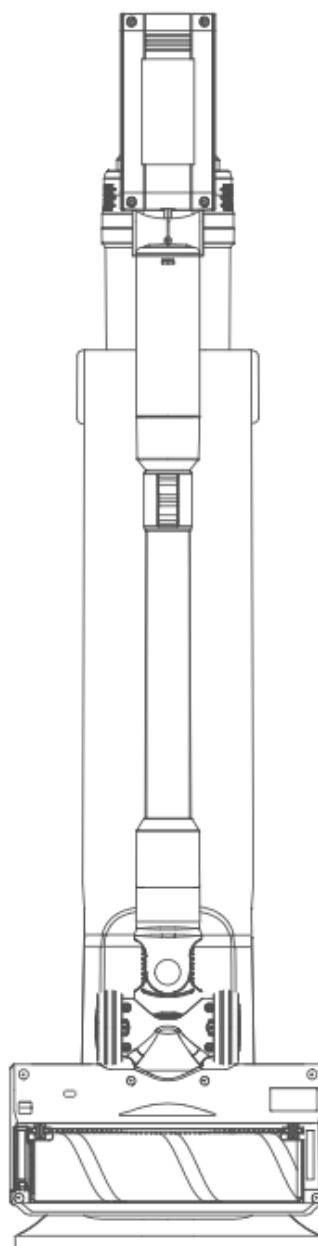
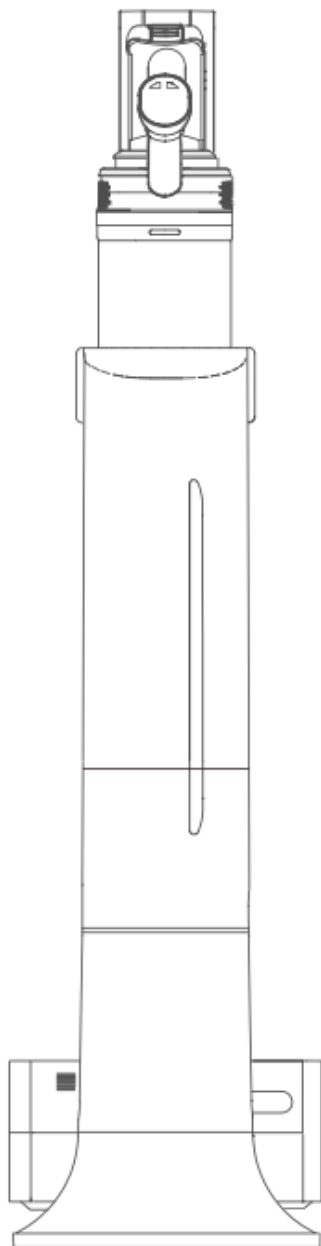

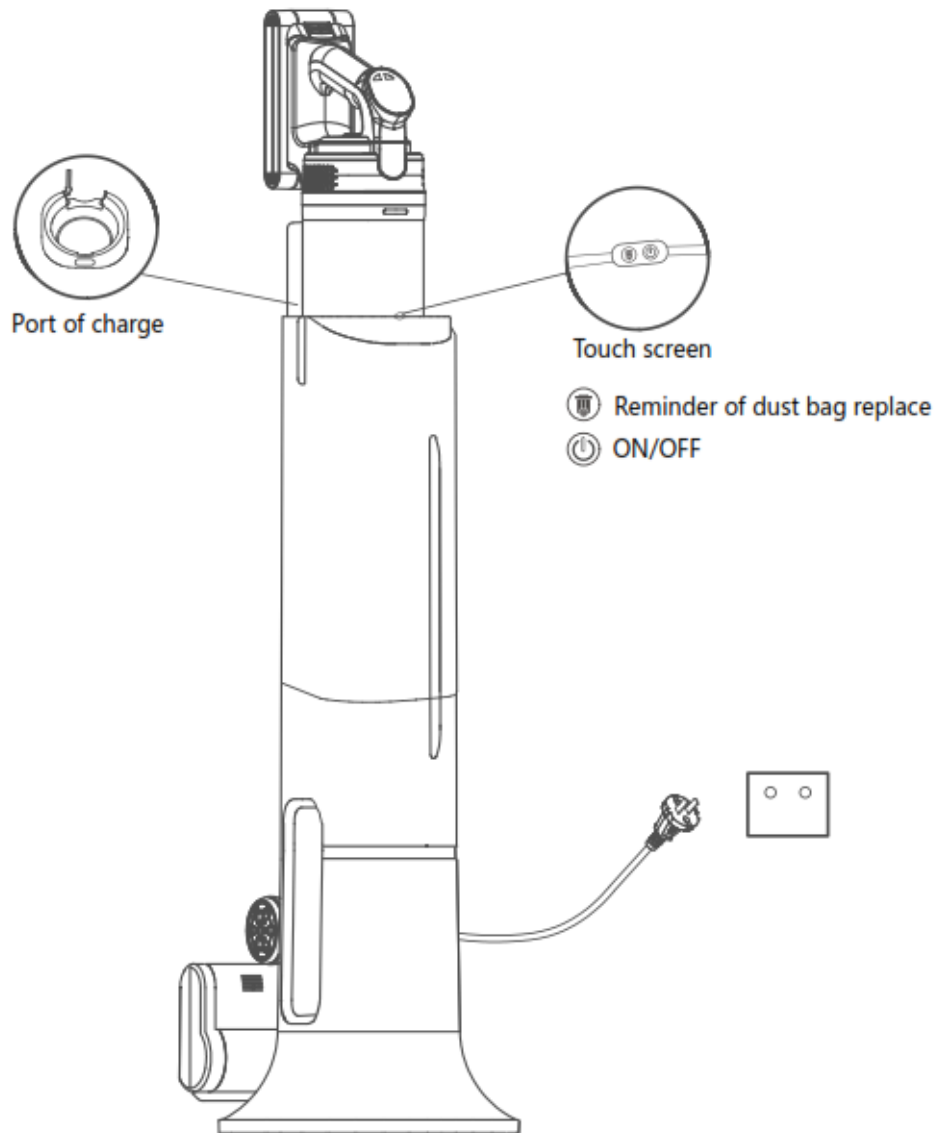

1. Connect the station to power and touch the "ON/OFF" button to turn it on.
2. After three cleaning cycles, 30 seconds each, the machine will turn off automatically and the lights will go out. The thimble will close the dust cup lid.
3. The inner device will monitor the suction of the cleaning station. When insufficient, the station will prompt you to replace the dust bag. This can be purchase by contacting malaysia@russelltaylors.co.uk.

MACHINE CLEANING

1. As shown in the image below, press the dust cup lock, the bottom will open automatically, the dust and garbage can be poured out.
2. Please put your finger on this button and pull it down in the direction of the arrow to remove the garbage that is entangled in the filter or stuck in the dust cup.

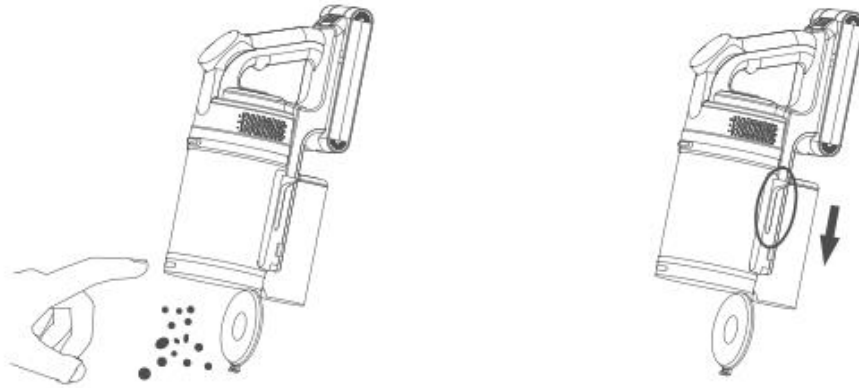

CLEANING THE OUTLET HEPA FILTER

1. Rotate counter clockwise as shown in the picture to remove the Outlet HEPA Filter from the machine and clean it with a soft brush (note: Do not clean it with water).

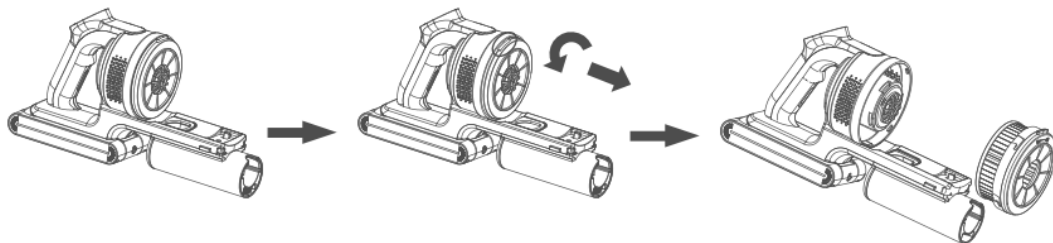

CLEANING THE MOTORIZED FLOOR BRUSH

1. The motorized floor brush must be cleaned after using for an extended period of time.

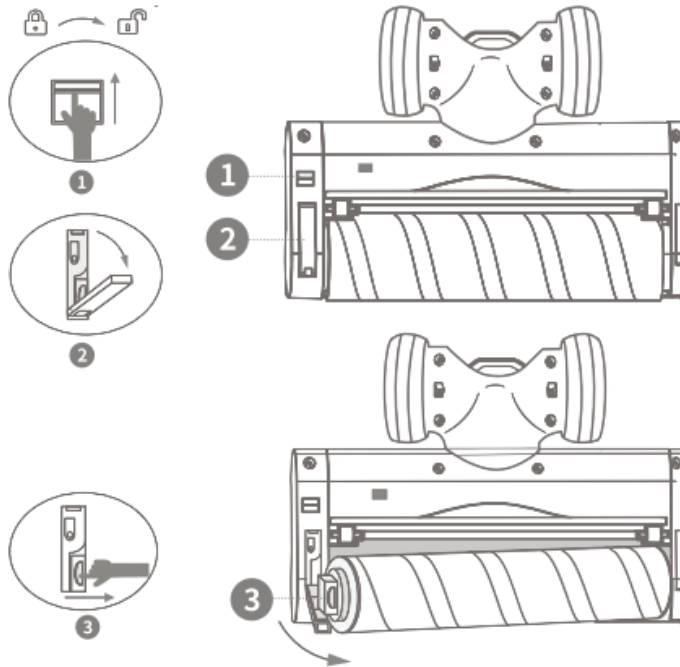

HOW TO CLEAN THE FILTER IN THE CLEANING STATION

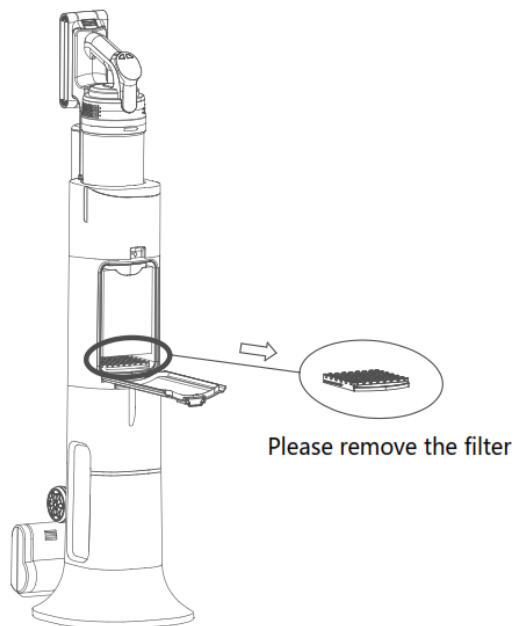

1. Clean the dust bag with a soft brush. Clean the filter with a soft brush or put it into water to clean and wash.
2. Reinstall after it is dry. We suggest washing it when you feel the suction is weaker.

ICON INDICATORS

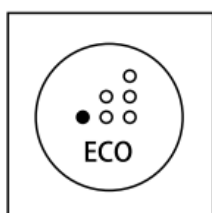

Mode Eco

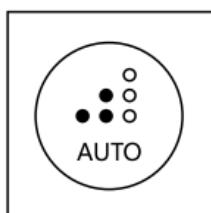

Mode Auto

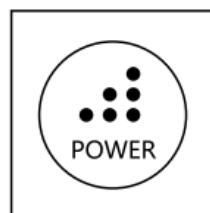

Mode Power

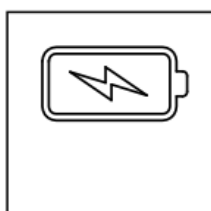

The battery power is low, at the same time three red lights of the battery pack flash

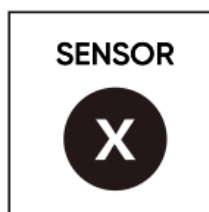

Means the host suction location of the dust sensor failure, need to consult after-sales

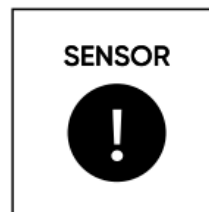

Means that dust is blocked at the suction position of the main machine. It is necessary to remove the telescopic tube to confirm and clean the dust at the suction port.

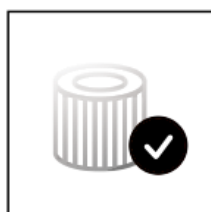

Means that the inlet hepa or suction inlet of dust cup is blocked. In this case, these components need to be checked and cleaned.

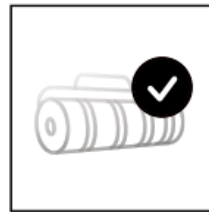

Means the soft roller brush is blocked by hair or garbage, which needs to be checked and cleaned.

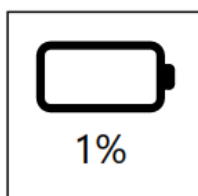

Battery 1%

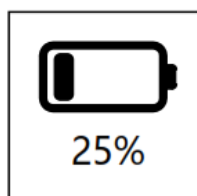

Battery 1-25%

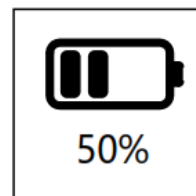

Battery 26-50%

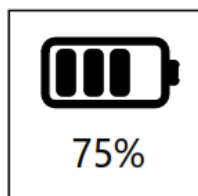

Battery 51-75%

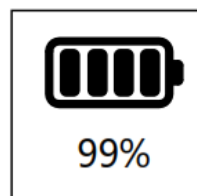

Battery 76-99%

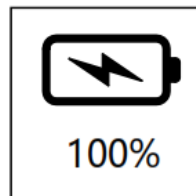

Full Battery

TROUBLESHOOTING

Issue	Possible Causes	Solution
Motorized brush is not working	Winding too much hair or other long impurities	Clean up the entanglements
Vacuum is not working	Low battery	Charge the battery
	Dust cup is full	Clear the dust cup container
	Overheat	Let it cool and restart
Vacuum suction is weak	The filter is full of dust	Clean or replace the dust cup culter
	The tube is blocked	Check the tube if there is any object blocking
Cleaning station has poor suction	The dust bag is full	Remove or clean the dust bag
Cleaning station is not working	No power	Connect to power
	The dust bag is full	Pour out the dust in the dust bag
	The vacuum is not placed properly	Place the vacuum cleaner into the cleaning station

If the LED Lights on the battery pack blink red, it may have the following faults

- The internal temperature of the machine is too high and the overheat prevention function has started to shut down the vacuum cleaner. Restart the vacuum when the body is cool and it will recover.
- The machine has short circuited and shut down after sucking liquid. Please do not start/shut down the machine repeatedly. Remove the battery for recharging and restart the machine.
- When the host motor is blocked, the machine will shut down automatically. Remove the foreign matter and restart.
- If the floor brush is blocked by foreign matter, the machine will not shut down automatically but the LED lights will turn red and flash. Shut down the machine, remove the foreign matters in the brush head and turn the vacuum back on again.
- When the power is low, the LED lights will flash red. Please charge immediately.

BATTERY SAFETY

- This appliance includes Li-ion batteries. Do not expose it to high temperature or it may explode.
- Lithium-ion batteries perform best when they are kept at a moderate state of charge and are not allowed to discharge (Battery level reaches 0%). To increase the lifespan of the battery pack, do not allow the battery to reach 0% and recharge the battery regularly.
- The batteries are not replaceable. If you have a defective battery pack, please contact the Russell Taylors service team at support@russelltaylors.com.